



S87

MECHANICAL KEYBOARD

Compatible with: Naraka, Energy Color Series



www.Bloody.com



Scan for E-Manual

COMBINATION FN KEYS

Default 10 Preset Lighting Effects



SWAP SWITCH STEP

How to Replace Switches?

The keyboard switches are hot-swappable and compatible with most the 3-pin & 5-pin mechanical switches on the market.

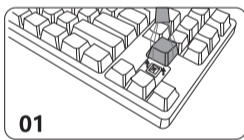

01 Remove the keycaps with the keycap puller.

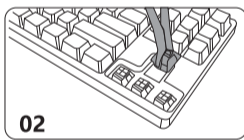

02 Remove the switches with the switch puller.

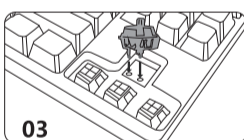

03 Line up the switch pins with the PCB socket.

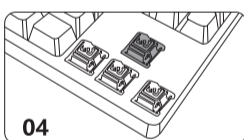

04 Place the switch on the PCB and integrate it closely.

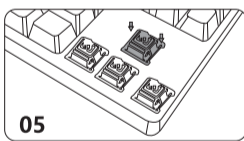

05 Gently press the switch into place.

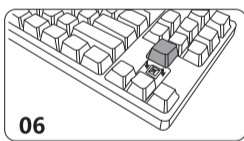

06 Put the keycaps back on to the keyboard and test it.

PACKAGE CONTENTS

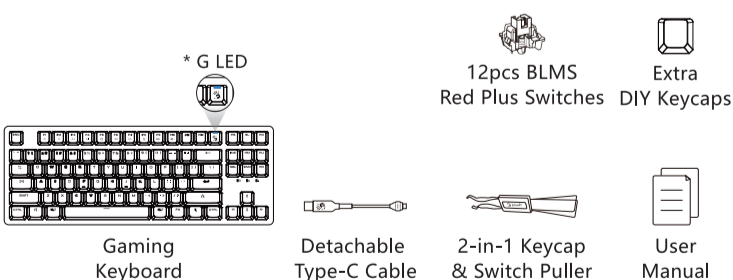

INSTALLATION

Connection

Connect the cable Type-C plug to the keyboard and the USB plug to the computer.

(Note: Using a USB hub or extension cable for connection is not recommended.)

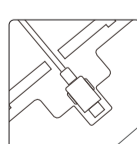

Software Download

For the best product performance, please download and install the software from <https://bloody.com/en/download.php>.